

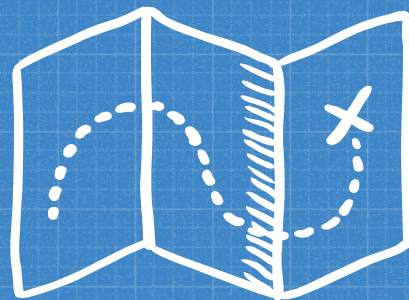

Construction Update

Today's Topics:

1. Recently Completed Work
2. In Progress Work
3. Upcoming Projects





1

2022 Ongoing and Recently Completed Work

Completed projects

- Interior renovations: MCE, WLE, SAE, RH0
- BDHS A31 Bakeshop
- Asphalt Repairs: SAE, LHC, BDHS east and south, OPS
- Education Center 1st floor interior offices

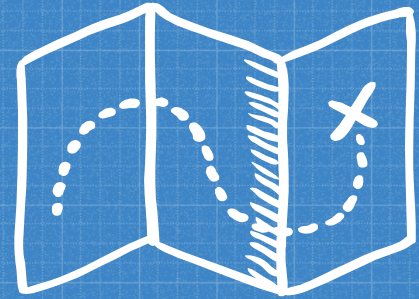

Ongoing Projects

- Building additions:MCE, ROE, WLE
- Interior renovations (ongoing): NGC, SFE
- BDHS Kitchen Serving line
- BDHS Theater/Auditorium
- BDHS MPA / Restroom Partitions
- BDHS fence at Football field
- BDHS Turf Building
- Roofing replacements:BDHS, ROE
- Asphalt repairs: BHDS, BDU, CHC, NWE

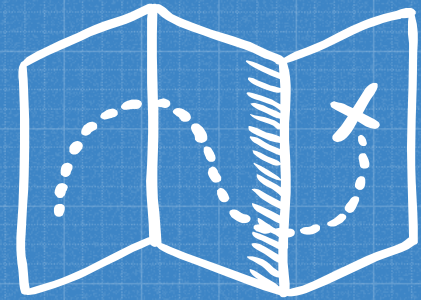

- Transportation - in design. Anticipated start spring of 2023.
- BDHS pool locker rooms and filtration - in design. Anticipate bid fall 2022 and construction start March 2023.
- BDHS Athletic Facilities/Band Practice Lot
- Veregy
 - Solar panels
 - Occupancy sensors
 - Equipment upgrades

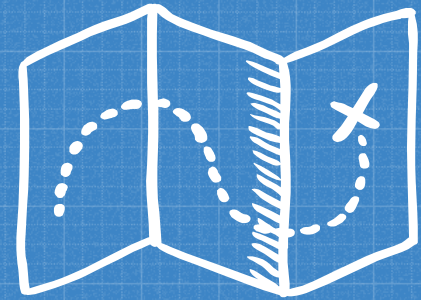

Tennis Courts at Ben Davis/CHC



McClelland And Westlake

- Classroom and corridor renovation
- VUV Upgrades
- Mechanical Improvements.



Old



New

Old vs new ventilation



McClelland



Asphalt repairs at LHC



A31 Bakeshop



Ed Center 1st Floor

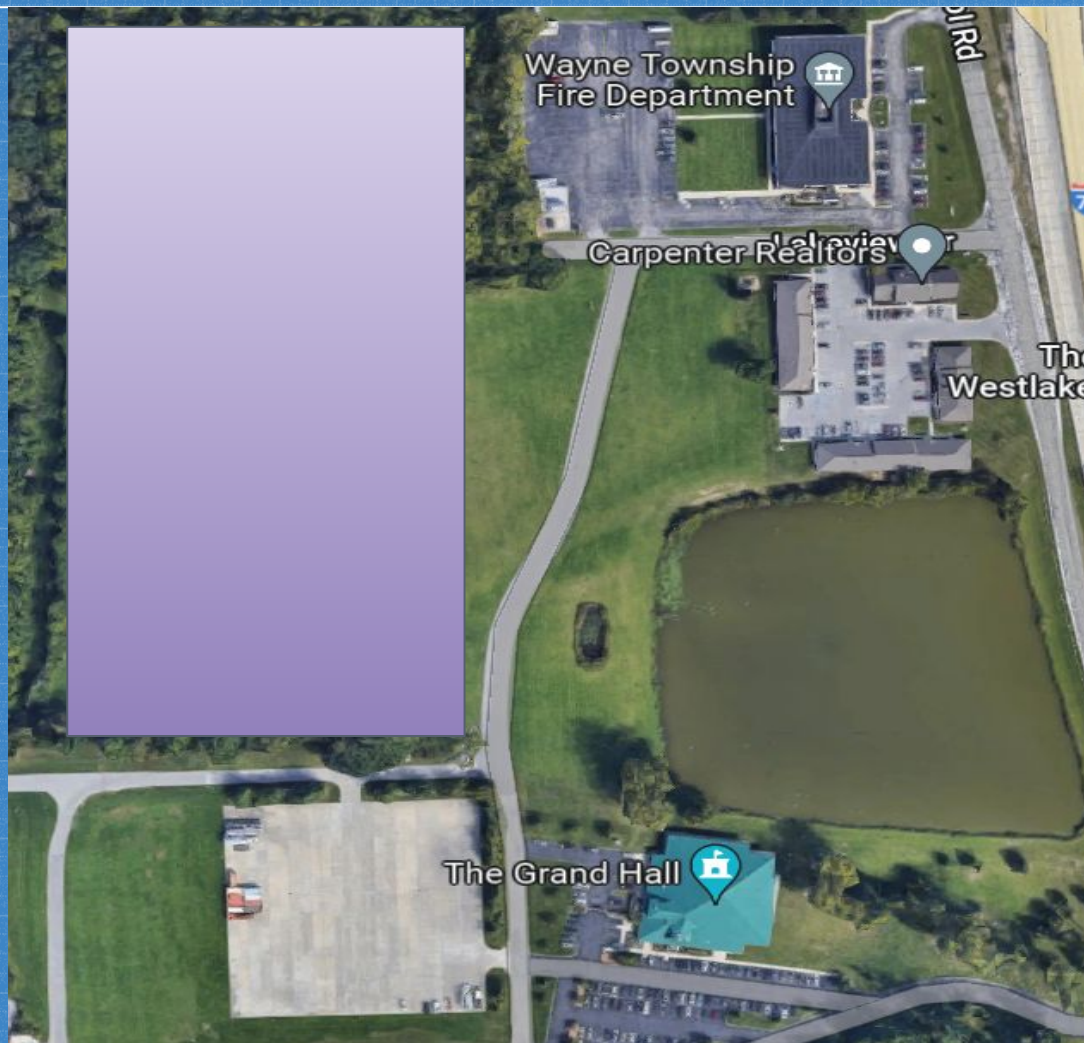

General location for
the transportation
center is West of the
MSDWT Fire Dept HQ

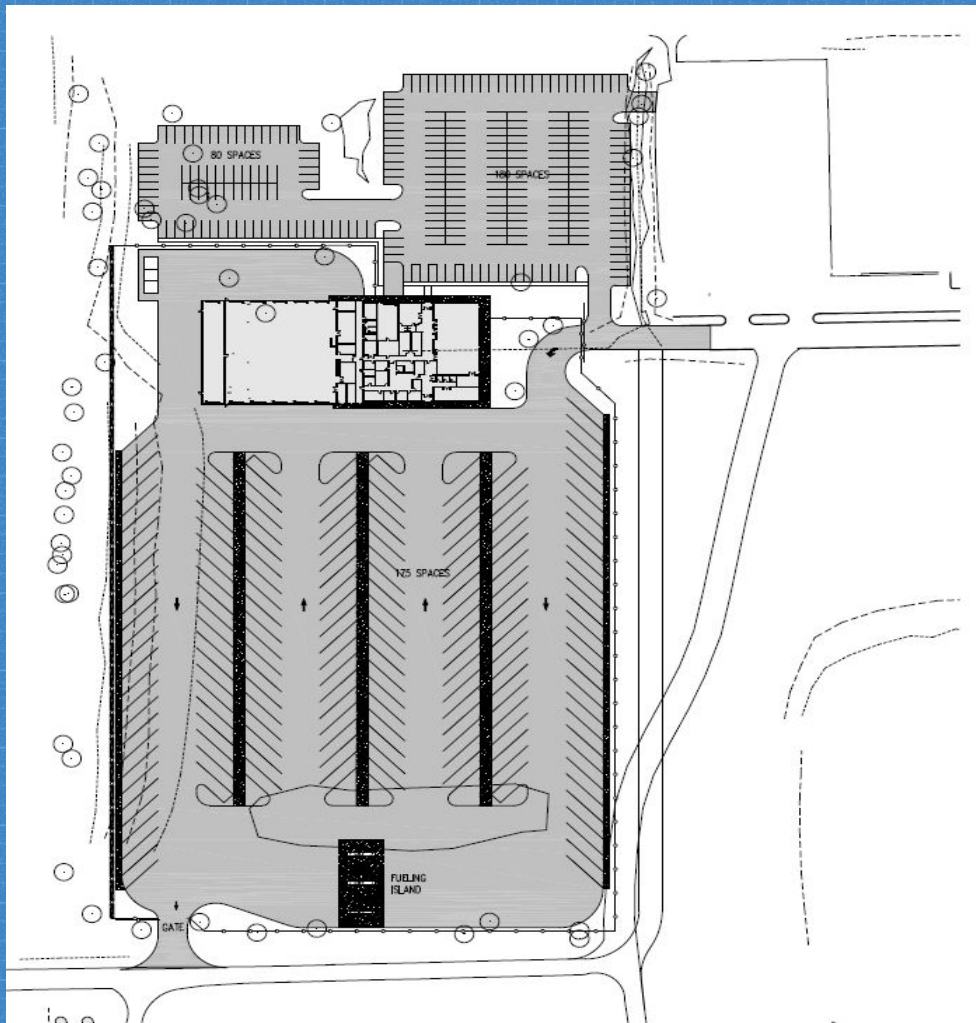

- Initial layout for the site includes additional parking for PD.
- Layout minimizes the impact to heritage trees and wetlands.



2

2023 Upcoming Projects

- Building additions:
 - Stout Field
 - Maplewood
 - Bridgeport
- Roofing replacements:
 - Chapelwood
 - North Wayne
- Asphalt repairs
 - BDHS North and West parking + loop road
 - BDU sidewalks
 - Various other sites under evaluation

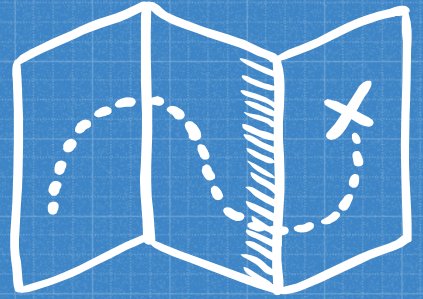

- Building Interiors (Refresh)
 - Under evaluation to potentially include (CHC, GCE, MWE)
- Building Roofs
- BDHS Cafeteria / Main Entrance / Clinic

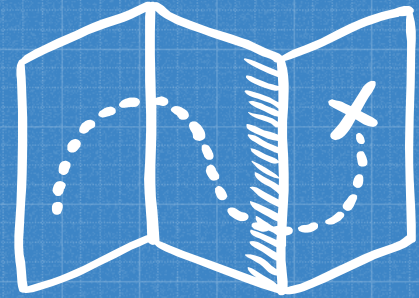



BDHS

Cafeteria Expansion

Today's Topics:

1. Needs assessment surrounding lunch schedule and how this impacts instruction time in the classroom
2. Potential options for expanding the cafeteria and reconfiguring adjacent spaces
3. Summary of timeline

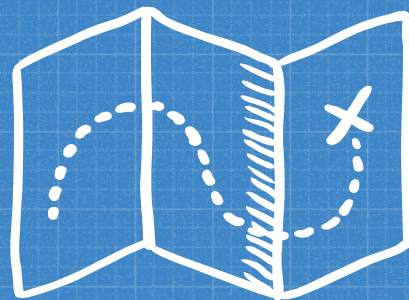



1 - Needs assessment

- Maximize instructional time
 - 5 lunches @ 24 mins = 120
 - 3 lunches @ 30 mins = 90

~40 additional instructional minutes
- Efficiencies for administrative supervision
- Increased accessibility for coursework in the master schedule
- Increased flexibility with scheduling

2 - Options for expanding cafeteria

- Expand the existing cafeteria east into the commons and media center.
- Build a second floor in the media center and move it upstairs to allow for more cafeteria space on the first floor.
- Reconfigure the north stair.
- Potential needed for additional space which may require moving further east into the clinic and admin areas. This will require further evaluation and planning to define the project boundaries and scope.
- Clinic and front entrance are already slated for renovations and may be wrapped into a larger project with the cafeteria expansion.

3 - Summary and Timeline

- Complete needs assessment - Q4 2022
- Initial design - Q1 2023
- Final design - Q2 2023
- Bid - Q3 2023
- Start construction Q4 2023

Thanks!

ANY QUESTIONS?

Barry Gardner

Elizabeth Walters

Sandra Squire

Dave Erickson

